



Installation instructions for part 95-7603

## Nissan 2007-up 95-7603

### KIT FEATURES

- ISO DDIN radio provision



### KIT COMPONENTS

- A) ISO DDIN trim plate

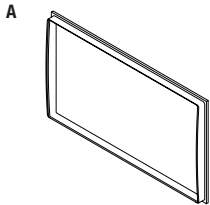

### WIRING & ANTENNA CONNECTIONS (sold separately)

Wiring Harness:

- 70-7552

Antenna Adapter:

- 40-NI12

### TOOLS REQUIRED

- Panel removal tool • Phillips screwdriver

**CAUTION!** All accessories, switches, climate controls panels, and especially air bag indicator lights must be connected before cycling the ignition. Also, do not remove the factory radio with the key in the on position, or while the vehicle is running.

## Applications

### Chevrolet

City Express (*without NAV*)..... 2015-up

### Nissan

Cube..... 2009-2014

Juke ..... 2011-2014

NV ..... 2012-2014

NV (*without NAV*)..... 2015-up

NV200 (*without NAV*)..... 2013-up

Quest (*without NAV or rear seat entertainment*)..... 2011-2012

Rogue..... 2011

Rogue S..... 2012-2013

Rogue SV (*with SL package*)..... 2012-2013

Rogue Select (*with lower model radio*)..... 2014-2015

Versa ..... 2007-2013

Versa S ..... 2014

Versa S+..... 2014

Versa SV (*base*)..... 2014

## Table of Contents

### Dash Disassembly

#### Chevrolet

– City Express (*without NAV*) 2015-up..... 6

#### Nissan

– Cube 2009-2014..... 6

– Juke 2011-2014 ..... 4

– NV 2012-up ..... 7-8

– NV200 (*without NAV*) 2015-up ..... 6

– Quest (*without NAV or rear seat entertainment*) 2011-2012..... 9-10

– Rogue 2011 ..... 5

– Rogue S 2012-2013..... 5

– Rogue SV (*with SL package*) 2012-2013 ..... 5

– Rogue Select (*with lower model radio*) 2014-2015 ..... 5

– Versa 2007-2011 ..... 3

– Versa 2012-2013 ..... 4

– Versa S 2014..... 4

– Versa S+ 2014 ..... 4

– Versa SV (*base*) 2014 ..... 4

### Kit Assembly

– ISO DDIN radio provision ..... 11

## Dash Disassembly

### Nissan Versa 2007-2011

1. Unclip and remove the panel above the radio. (Figures A and B)
2. Unclip and remove the entire trim panel surrounding the radio and A/C controls. (Figure C)
3. Remove (4) Phillips screws securing the radio. (Figure D)

*Continue to kit assembly*

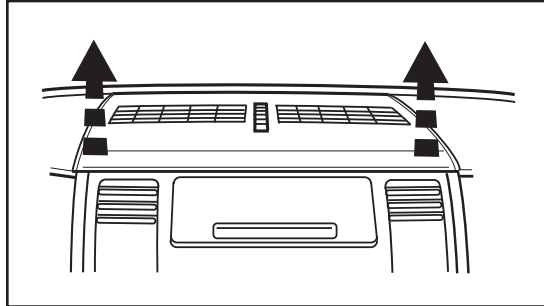

(Figure A)

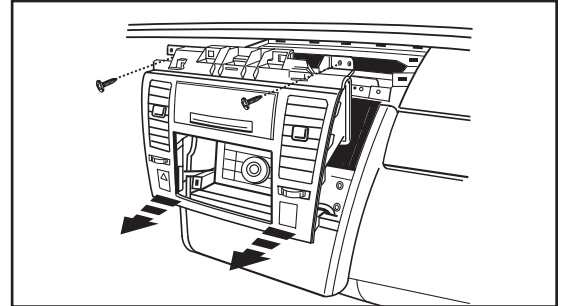

(Figure C)

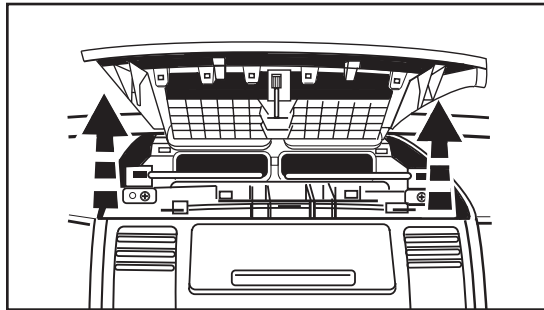

(Figure B)

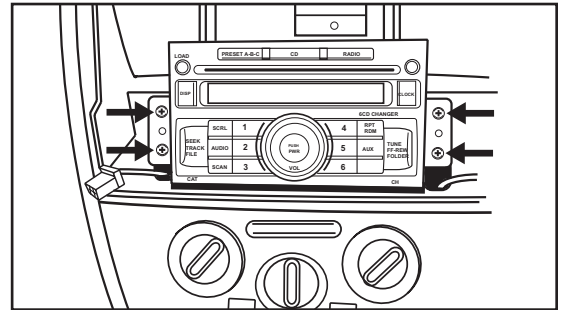

(Figure D)

## Dash Disassembly

### Nissan Versa S, Versa S+, Versa / SV (base) 2014, Versa 2012-2013

1. Unclip and remove the entire panel surrounding the radio including the A/C vents. (Figure A)
2. Remove (4) Phillips screws securing the radio. (Figure B)

*Continue to kit assembly*

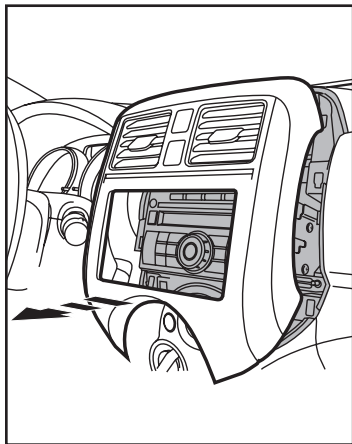

(Figure A)

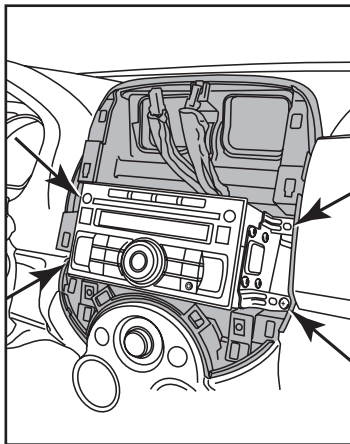

(Figure B)

### Nissan Juke 2011-2014

1. Unclip and remove the climate control panel. (Figure A)
2. Remove (2) Phillips screws securing the radio trim panel. (Figure B)
3. Remove (4) Philips screws securing the radio. (Figure C)

*Continue to kit assembly*

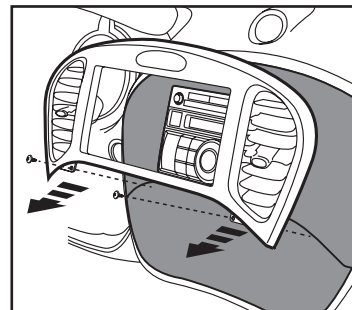

(Figure B)

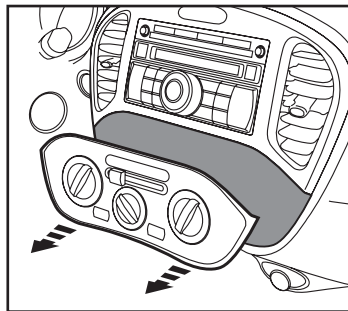

(Figure A)

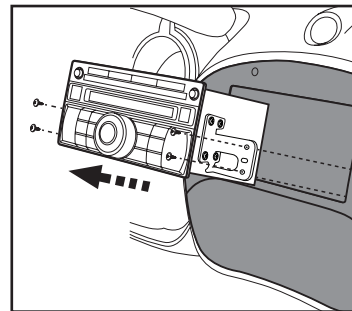

(Figure C)

## Dash Disassembly

**Nissan Rogue 2011, Rogue S 2012-2013, Rogue SV (with SL package) 2012-2013, Rogue Select (with lower model radio) 2014-2015**

1. If equipped with center speaker: Unclip and remove the grille then remove (4) Phillips screws to remove the speaker. (Figure A)
2. Unclip and remove the panel below the radio including the A/C controls. (Figure B)
3. Unclip the radio trim including the A/C vents then unplug the hazard switch and remove the panel. (Figure C)
4. Remove (4) Phillips screws securing the radio. (Figure D)

*Continue to kit assembly*

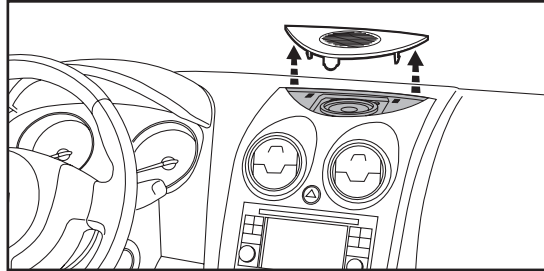

(Figure A)

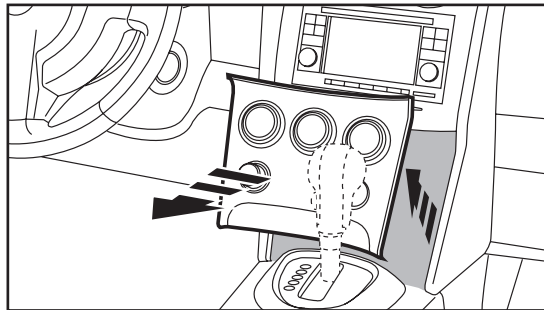

(Figure B)

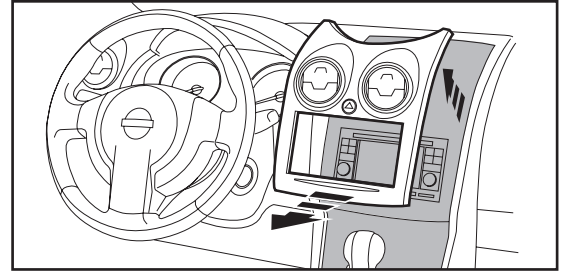

(Figure C)

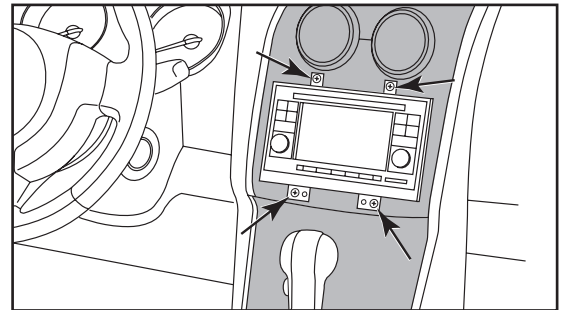

(Figure D)

## Dash Disassembly

**Chevrolet City Express (without NAV)  
2015-up**

**Nissan Cube 2009-2014**

**Nissan NV200 (without NAV) 2013-up**

1. Unclip and remove the recirculate/ fresh slide button. (Figure A)
2. Unclip and remove the entire panel surrounding the radio including the a/c vents. (Figure B)
3. Remove (4) Phillips screws securing the radio. (Figure C)

*Continue to kit assembly*

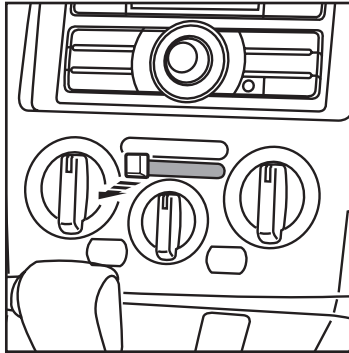

(Figure A)

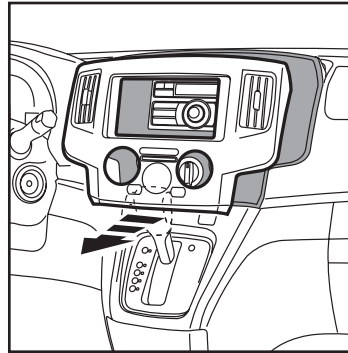

(Figure B)

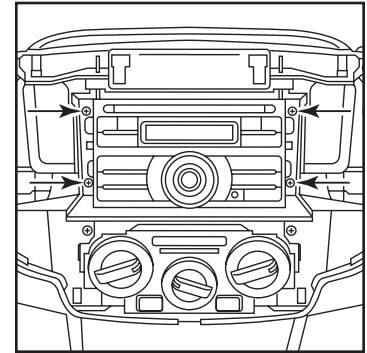

(Figure C)

## Dash Disassembly

**Nissan NV 2012-2014,  
Nissan NV (without NAV) 2015-up**

1. Unclip and remove the A/C vent to the right side of the factory radio. (Figure A)
2. Remove the (2) Phillips screws exposed behind vent on radio trim panel. (Figure B)
3. Unclip and remove the left A/C vent next to the instrument display. (Figure C)
4. Unclip the top edge of the knee bolster panel below the steering column and let hang. (Figure D)

*Continue on the next page*

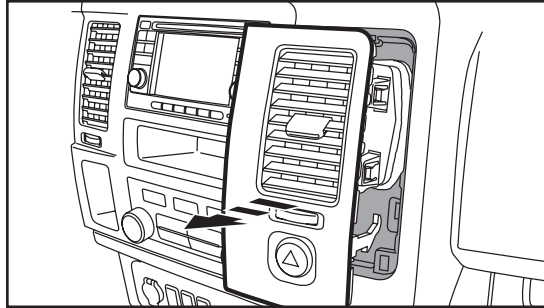

(Figure A)

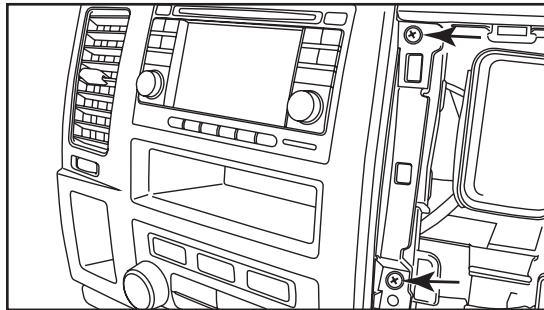

(Figure B)

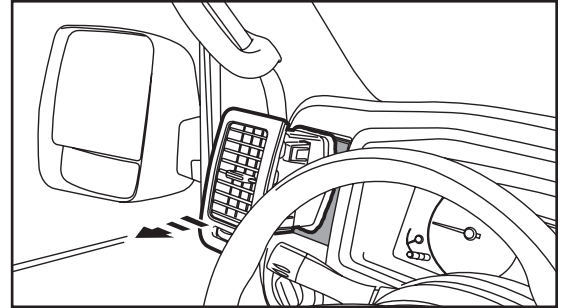

(Figure C)

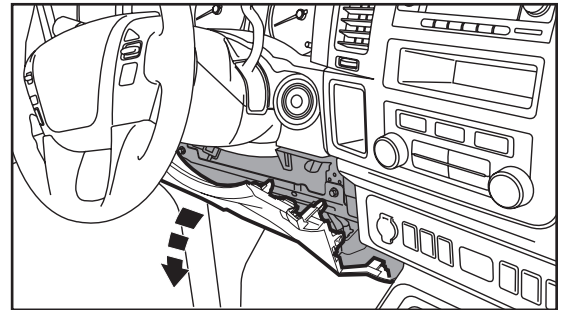

(Figure D)

## Dash Disassembly (Cont)

**Nissan NV 2012-2014,  
Nissan NV (without NAV) 2015-up**

5. Unclip the circle trim around the key cylinder.
6. Unclip and remove the gauge cluster trim panel. (Figures E)
7. Remove (2) Phillips screws exposed behind the panel on the left side of the radio trim panel. (Figure F)
8. Unclip and remove the trim panel surrounding the factory radio. (Figure G)
9. Remove (4) Phillips screws securing the radio. (Figure H)

*Continue to kit assembly*

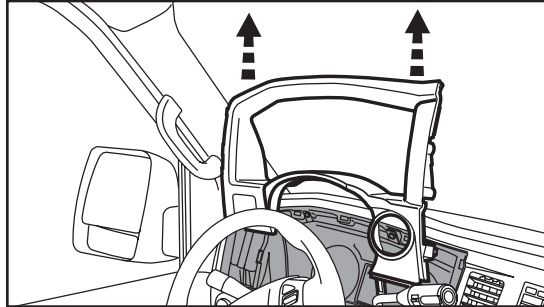

(Figure E)

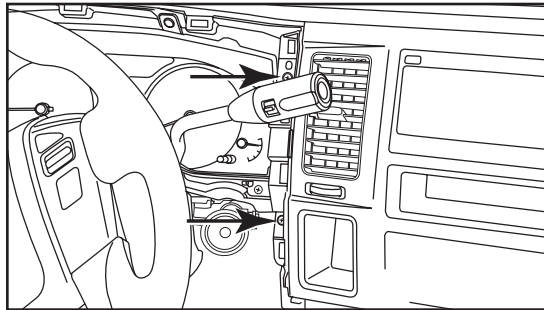

(Figure F)

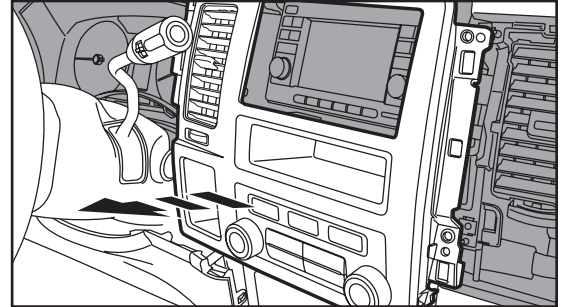

(Figure G)

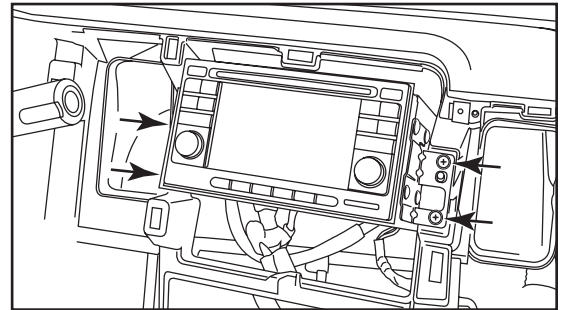

(Figure H)



## Dash Disassembly

**Nissan Quest (without NAV or rear seat entertainment) 2011-2012**

1. Unclip and remove the panels from the bottom left and right side of the center console. (Figure A)
2. Remove (2) clips per side exposed behind lower panels. (Figure B)
3. Unclip and pull center console toward rear of vehicle. (Figure C)

**Note:** You do not have to fully remove console.

4. Unclip and remove the trim panel to the left of the shifter housing the start/stop button. (Figure D)

*Continued on the next page*

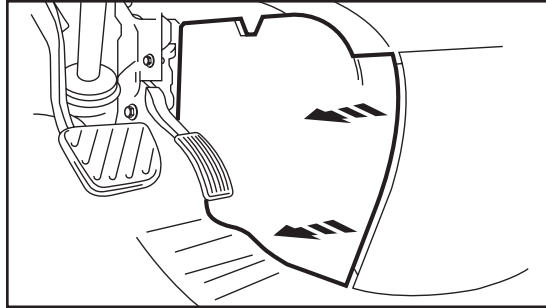

(Figure A)

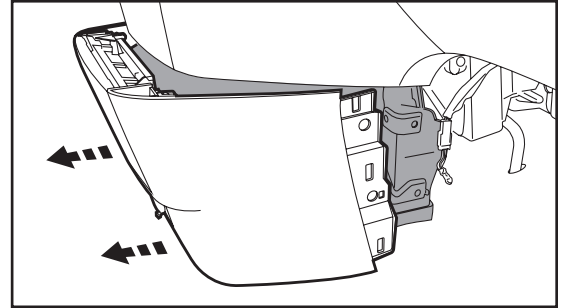

(Figure C)

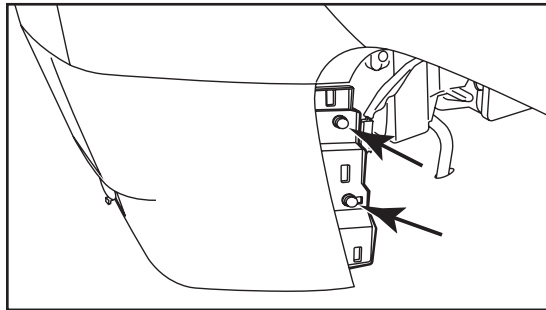

(Figure B)

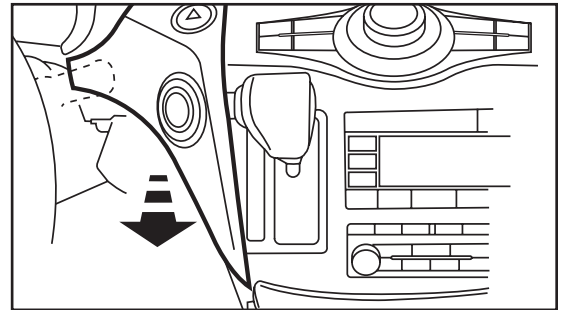

(Figure D)

## Dash Disassembly (Cont)

**Nissan Quest** (without NAV or rear seat entertainment) 2011-2012

5. Unclip and remove the panel on the end of the passenger side of the dash. (Figure E)
6. Remove (1) Phillips screw from the trim panel above the glove box then unclip and remove the panel. (Figure F)
7. Remove (1) Phillips screw from the cup holder panel then unclip and remove the panel. (Figure G)
8. Remove (2) Phillips screws from the A/C control panel and unclip and let hang. (Figure H)
9. Remove (2) Phillips screws from the bottom of the radio trim panel including the vents then unclip and remove the panel. (Figure I)
10. Remove (4) Phillips screws securing the radio. (Figure J)

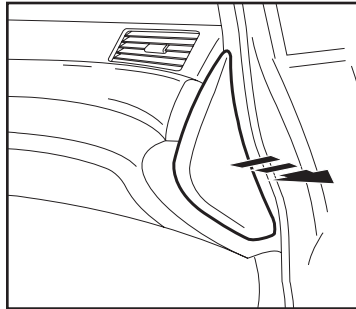

(Figure E)

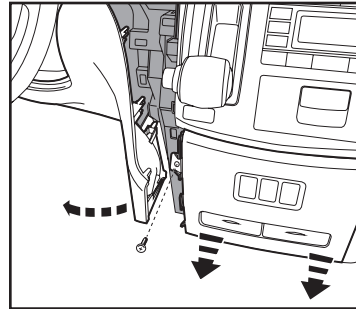

(Figure F)

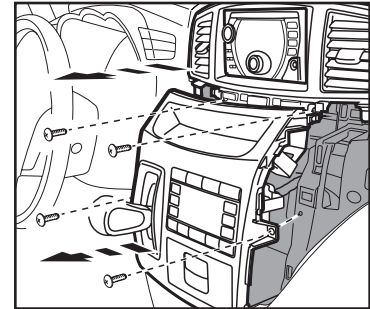

(Figure G)

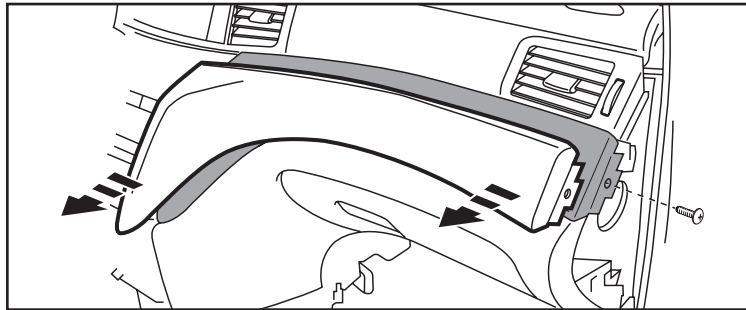

(Figure H)

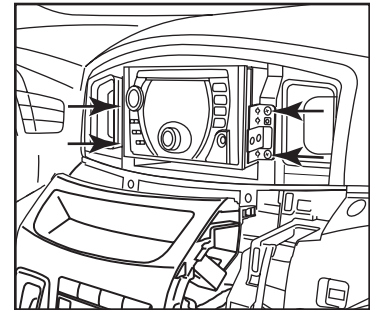

(Figure I)

*Continue to kit assembly*

## Kit Assembly

### ISO DDIN radio provision

1. Remove the brackets from the factory radio.
2. Secure the brackets to the aftermarket radio using the screws supplied with the aftermarket radio. (Figure A)
3. Locate the factory wiring harness and antenna connector in the dash. Metra recommends using the proper mating adapters from Metra and/or AXCESS.
4. Place the *ISO DDIN trim plate* on the front of the radio. (Figure B)
5. Reassemble the dash in reverse order of disassembly.

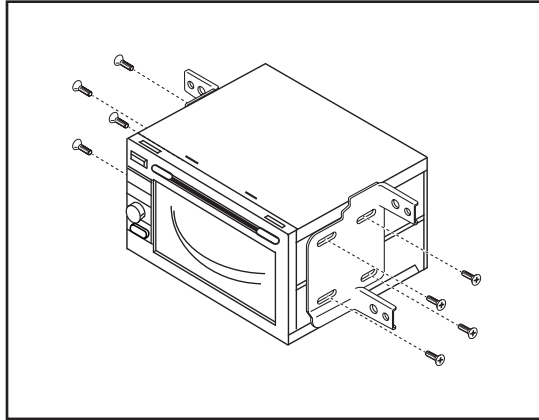

(Figure A)

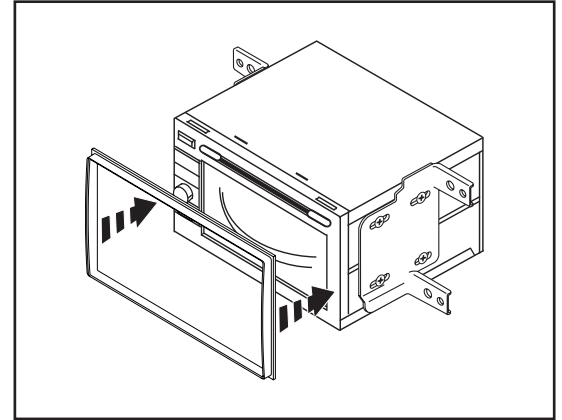

(Figure B)



Installation instructions for part 95-7603



## IMPORTANT

If you are having difficulties with the installation of this product, please call our Tech Support line at **1-800-253-TECH**. Before doing so, look over the instructions a second time, and make sure the installation was performed exactly as the instructions are stated. Please have the vehicle apart and ready to perform troubleshooting steps before calling.



### KNOWLEDGE IS POWER

Enhance your installation and fabrication skills by enrolling in the most recognized and respected mobile electronics school in our industry. Log onto [www.installerinstitute.com](http://www.installerinstitute.com) or call 800-354-6782 for more information and take steps toward a better tomorrow.



**Metra recommends MECP  
certified technicians**

REV. 12/14/2016 INST95-7603